

The Programming Cable

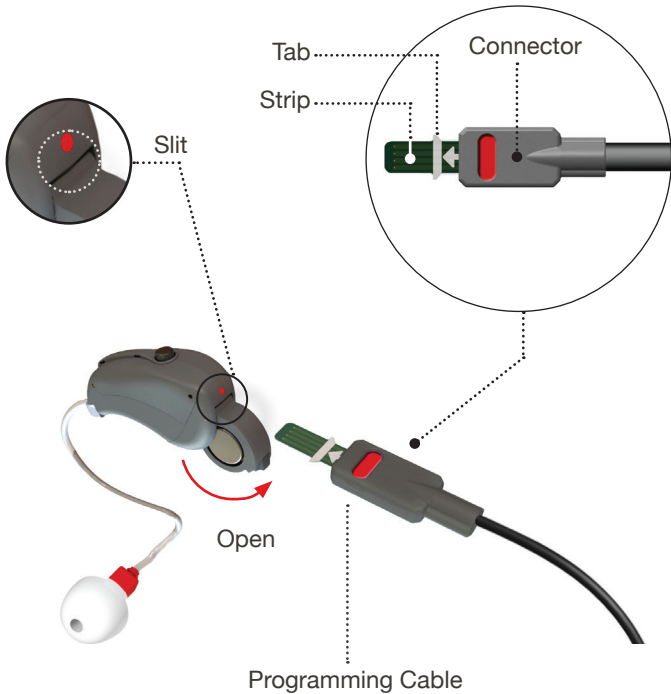

Connecting the Programming Cable to the device

OPEN the battery door halfway, make sure the colored line on the connector matches and aligns with the colored dot on the device (make sure a battery is inserted into the

Connecting the Programming Cable to the device

- 1) **GENTLY INSERT** the Programming Strip until the Tabs are flush against the Slit under the dot on the device.
- 2) **CLOSE** the battery door with the battery inside to secure the Programming Strip.

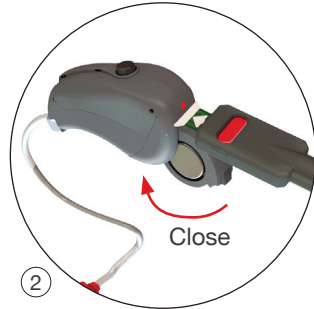
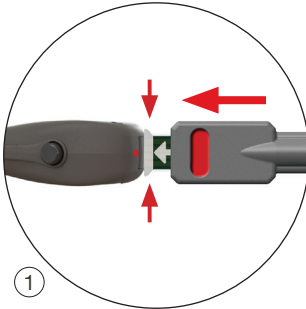

Disconnecting the Programming Cable from the device

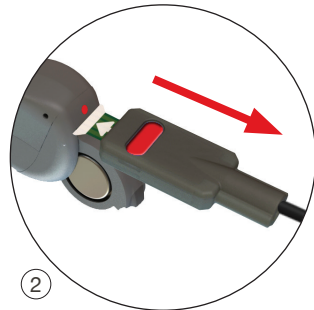
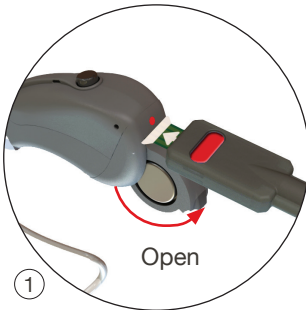

- 1) **OPEN** the battery door partially.
- 2) **GENTLY PULL** the Programming Connector away from the device.